

# Karma AcoustiWall

## Technical Datasheet

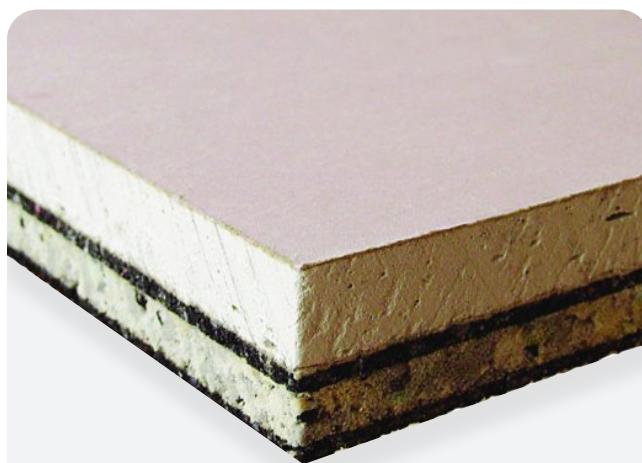

**Karma AcoustiWall** 30mm, is a high performance acoustic wall lining system engineered to significantly reduce airborne sound transmission through new and existing masonry walls. Installed directly to the walls, the system does not require timber battens or resilient bars, significantly reducing its impact on room space. The slim design, makes it ideal for existing properties where space is a premium, or new builds featuring lightweight block walls. **Karma AcoustiWall** is also suitable for the refurbishment of existing masonry walls that are to be converted into partition or separating walls between dwellings. The easy to fit, slimline wall lining system is an ideal solution for domestic and commercial properties that require improved soundproofing without compromising space.

### Application

**Karma AcoustiWall** is a direct to partition and masonry wall solution, suitable for new or existing walls that require acoustic improvement to comply with Part E building regulations. The 30mm **Karma AcoustiWall** system is typically fixed with M6 X 65mm metal nailings or drywall screws to new/ existing block/ brick walls and partitions. The system should be taped and jointed or plaster finished for decoration. When installed the **Karma AcoustiWall** will significantly reduce airborne noise transmission.

### Flanking Floors

Floors connected to the separating wall can carry both airborne and impact sound to the rooms above, below or adjacent, making it essential potential gaps and junctions are remedied. For additional information about potential junctions in your installation and to get the best performance from your **Karma AcoustiWall** system, please contact the Acoustec technical team using the details below.



Product made of recyclable materials



0 - Global Warming Potential of resilient layer

### Key Benefits



Reduces airborne sound through new and existing walls



Super slim - Only 30mm thick



Quick and easy to install



One product solution

### Accessories

- Acoustic Sealant (flanking strip)
- Metal Nailin's M6 x 65 (Masonry Walls)

### Technical Information

|                |                        |
|----------------|------------------------|
| Surface Weight | 20kg/m <sup>2</sup>    |
| Weight         | 28kg/m <sup>2</sup>    |
| Density        | 677kg/m <sup>3</sup>   |
| Dimensions     | 1200mm x 1200mm x 30mm |
| Sheet Coverage | 1.44 m <sup>2</sup>    |

### Acoustic Performance

|                                    |      |
|------------------------------------|------|
| Speaker icon Airborne Sound Rating | 65dB |
| Wrench icon Impact Sound Rating    | 56dB |

# Karma AcoustiWall

## Installation Guide

### Required Materials

- **Karma Acoustiwall**  
30mm Acoustic Wall Lining board (30 x 1200 x 1200mm)
- Karma Acoustic/Fire mastic (310ml tube)
- Karma M6 x 65mm metal nailins
- Taping and jointing materials / finish plastering materials

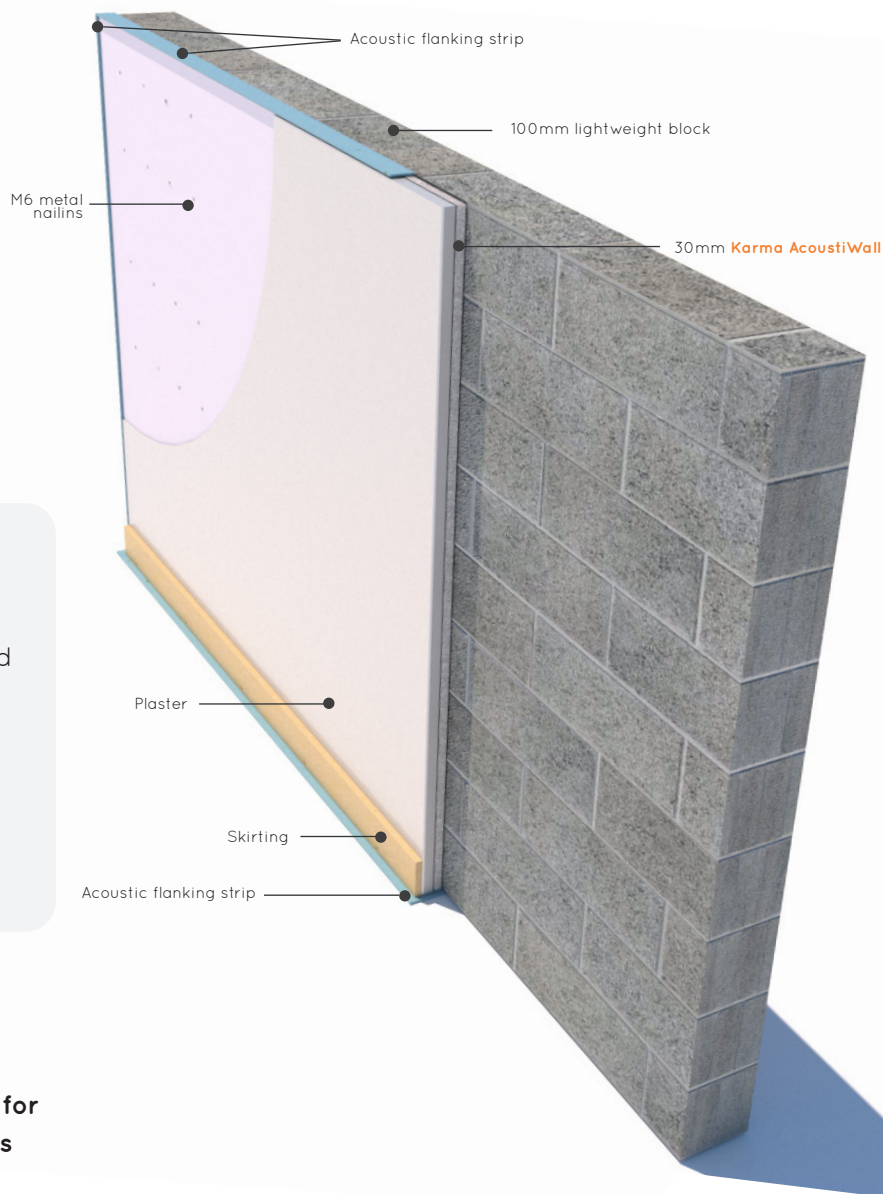

### Installation Process

#### Technical installation guide for Karma AcoustiWall acoustic wall lining system for pre-completion testing of masonry walls

- 1 Prior to the installation of the **Karma AcoustiWall** wall lining system, the buildings roof and the windows must be in place.
- 2 Remove existing skirting, cornice/coving, sockets or switches. Ensure the surface of the wall is flat and free of debris.
- 3 Position the **Karma AcoustiWall** up to the wall, with the pink board facing out to ensure a flat and stable position.
- 4 Support the **Karma AcoustiWall** 30mm acoustic wall lining board firmly against the wall whilst drilling 5x M6 holes, through the panel and into the block/brick wall, 200mm in and down from each corner and 1 to the centre.
- 5 Using a hammer, insert the 5 Karma M6 x 65mm Metal Nailin fixings through the panel into the block/brick behind to a depth where the head of the fixing slightly indents into the pink board flush with the surface.
- 6 Continue installing the **Karma AcoustiWall** acoustic wall lining panels in a brick fashion until the separating/party wall is completely covered ensuring minimal spaces/gaps between the abutted joints.
- 7 Apply the Karma acoustic/fire mastic to all abutted joints and perimeter joints between floors, walls and ceilings.
- 8 Apply jointing tape to all board joints, apply finishing plaster ready for decoration.
- 9 **Electrical Sockets/Switches:** In areas which contain electrical sockets/switches ensure cables are brought through to the front of the **Karma AcoustiWall** acoustic wall lining board using a small hole. Using the Karma Acoustic/Fire mastic seal the hole around the cable, install suitable electrical boxes for plasterboard walls, install Karma Acoustic/Fire Putty Pads (data sheet and installation guides available) to the boxes, connect cables and affix switch/socket face plate.
- 10 **Cornice/Coving:** Install cornice/coving in accordance with the manufacturer's instruction.
- 11 **Skirting Boards:** Install skirting boards in the usual manner used with plasterboard partitions and according to manufacturer's instruction.

**For project specific guidance and help with installation, use the contact details to speak to our team today.**