

A wire hanging kit with a locking device solution for the suspension of a variety of services. Designed with a clever, keyless release mechanism.

FEATURES / BENEFITS

- The HF Express No. 1 is ideal for signage, shopfitting, lighting and other lightweight fixtures
- The HF Express No. 2 is ideal for mechanical and electrical applications
- Up to six times faster to install than traditional methods
- Keyless, no tool required for adjustment
- Ergonomic buttons allow rapid adjustment
- Discreet and aesthetic design
- Supplied as a ready-to-use kit



INSTALLATION & ADJUSTMENT

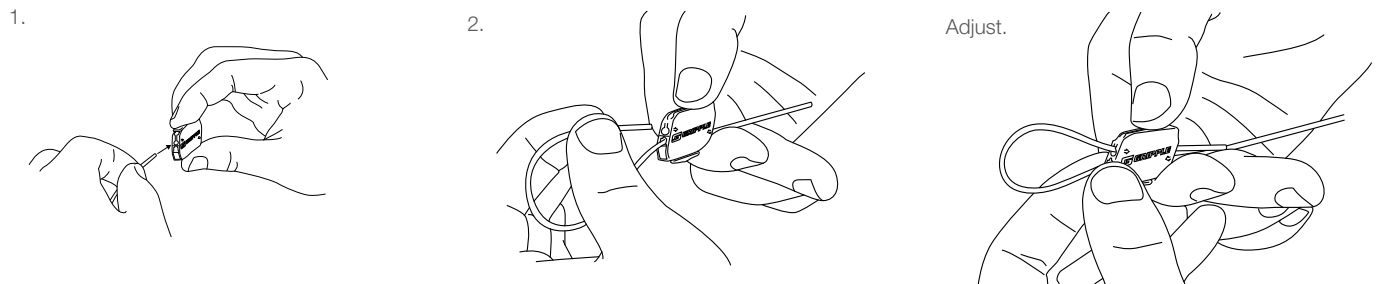

Ensure a minimum 75 mm of tail wire exit the hanger.

SPECIFICATION

HF Express No. 1

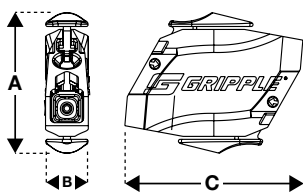

HF Express No. 2

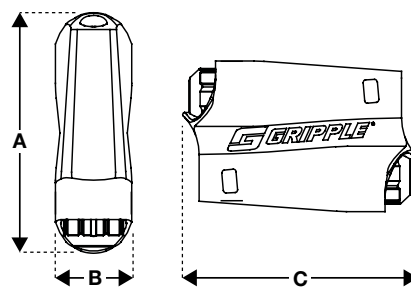

Dimension	No. 1 (mm)	No. 2 (mm)
A	18,5	21,4
B	5,9	11,6
C	23,5	28,4

AVAILABLE END FIXINGS



For more options on available end fixings please contact us or visit www.gripple.com

SUBMITTAL INFORMATION

Safe Working Load:

No. 1 – 15 kg @ 5:1 safety factor
No. 2 – 45 kg @ 5:1 safety factor

Material:

Housing – Type ZA2 Zinc
Wedge – Sintered steel hardened to min. 56 Rockwell C

Spring – Stainless Steel (Type 302)

End Cap – UV stabilised homopolymer propylene

No. 1 Button – Acetal

No. 2 Button – 30% Glass filled polypropylene